

Vieh- und Pferdeschermaschine	Originalbetriebsanleitung
Cattle and Horse Clipper	Translation of the original instructions
Tondeuse à chevaux et à bétail	Traduction de la notice originale
Tosatrice per equini e bestiame	Traduzione delle istruzioni originali
Esquiladora para bovinos y equinos	Traducción del manual original
Vee- en paardenscheermachine	Vertaling van de oorspronkelijke gebruiksaanwijzing
Kreatur- og hesteklipper	Oversættelse af den originale brugsanvisning
Klippmaskin för boskap och hästar	Översättning av bruksanvisning i original
Klippemaskin for hest og storfe	Oversettelse av den originale brukerveiledningen
Trimmeri naudoille ja hevosiille	Alkuperäisten ohjeiden käännös
Máquina de tosquiar gado e cavalos	Tradução do manual original
Κουρευτική μηχανή βοοειδών και αλόγων	Μετάφραση πρωτοτύπου οδηγιών χρήσης



Contents

1 IMPORTANT SAFEGUARDS	24
2 General	25
2.1 Warranty provisions	25
2.2 Customer service.....	25
2.3 Limitation of liability	25
2.4 Copyright	26
2.5 Symbols used	26
2.6 Intended use	26
3 Safety	27
3.1 General.....	27
3.2 Personnel requirements	27
3.3 Dangers that can be caused by the device	28
3.4 Personal Protective Equipment (PPE).....	30
4 Specifications	31
4.1 Clipper	31
4.2 Charger and power pack	31
4.3 Battery	31
4.4 Operating conditions.....	31
5 Construction and functions	32
5.1 Construction	32
5.2 Functional description.....	32
6 Transport, packaging and storage	33
6.1 Box contents	33
6.2 Packaging.....	33
6.3 Storage	33
7 Operation	34
7.1 Requirements at the place of use.....	34
7.2 Setting up the charger	34
7.3 Charging the batteries	34
7.4 Charging status display	36
7.5 Adjusting the clipping pressure.....	37
7.6 Switching the clipper on and off.....	37
7.7 Using the clipper	37
7.8 Replacing the clipping blades.....	38
7.9 Lubrication	39
7.10 Cleaning	40
8 Troubleshooting	41
8.1 Safety instructions	41
8.2 Causes of malfunctions and their rectification.....	41
9 Spare parts	43
10 Disposal	45

1 IMPORTANT SAFEGUARDS

DANGER

DANGER Commercial Clipper. When using an electrical appliance, read all instructions before use.

To reduce the risk of electric shock:

- ▶ Do not reach for an appliance that has fallen into water. Unplug immediately.
- ▶ Do not place or store appliance where it can fall or be pulled into a tub or sink.
- ▶ Do not place in or drop into water or other liquid.
- ▶ Unplug this appliance before cleaning, putting on, or taking off parts.
- ▶ Keep unit dry at all times.

CAUTION

WARNING Commercial Clipper. When using an electrical appliance, read all instructions before use.

To reduce the risk of burns, fire, electric shock, or injury to persons:

- ▶ An appliance should never be left unattended when it is plugged in (except for charging).
- ▶ Close supervision is necessary when this appliance is used by vulnerable persons.
- ▶ Use this appliance only for its intended use as described in this manual. Do not use attachments not recommended by the manufacturer.
- ▶ Never operate this appliance if it has a damaged cord or plug, if it is not working properly, if it has been dropped or damaged, or dropped into water. Return the appliance to a service center for examination and repair.
- ▶ Keep the charger cord away from heated surfaces.
- ▶ Never drop or insert any object into opening.
- ▶ Do not use this appliance with a damaged or broken comb or blade, as cut or scratched skin may result.
- ▶ Do not wrap cord around unit when storing. Continuous stress on the charger cord can damage cord insulation and result in a shock hazard.
- ▶ Avoid contact with moving blades.
- ▶ To disconnect, move the on/off switch to "OFF", then remove plug from outlet.
- ▶ During use, do not place or leave the appliance where it is expected to:
 - ◆ subject to damage by animal, or
 - ◆ exposed to weather.
- ▶ This appliance is for clipping and trimming animals only.
- ▶ Avoid tangling or kinking the cord while clipping. Should the cord become tangled or kinked, stop clipping and straighten the cord.

Continued on next page

- ▶ This appliance is not intended for use by persons, (including children) with reduced physical, sensory or mental capabilities, or lack of experience and knowledge, unless they have been given supervision or instruction concerning use of the appliance by a person responsible for their safety.
Children should be supervised to ensure that they do not play with the appliance.
- ▶ Ensure that your clipper is serviced only by a qualified repair person.

DO NOT USE THIS CLIPPER UNTIL YOU HAVE READ THESE OPERATING INSTRUCTIONS.

OPERATE ON VOLTAGE SPECIFIED ON CLIPPER.

SAVE THESE INSTRUCTIONS.

2 General

These instructions make it possible for you to use this device safely and efficiently. Read these instructions carefully before beginning to use the equipment.

A basic prerequisite for working safely is respecting all stated safety instructions and handling instructions in this manual.

Retain these instructions permanently. If you pass on the device to a third party, also give them these instructions.

2.1 Warranty provisions

Warranty provisions may be found in the manufacturer's General Terms and Conditions.

2.2 Customer service

Our customer service department and our authorised service centres are available for technical information.

In addition, our employees are always interested in new information and feedback resulting from usage, which could be valuable in improving our products.

2.3 Limitation of liability

All statements and tips in this manual were assembled by taking into consideration applicable standards and regulations, the latest technology and insights gained from our many years of experience.

The manufacturer assumes no liability for damages caused by:

- Ignoring the operating instructions.
- Non-intended uses of the device.
- Use by untrained personnel.
- Technical alterations.
- Use of non-original spare parts.

The actual goods delivered can deviate from the explanations and images presented here in the case of special versions, the utilization of additional ordering options or as a result of

the latest technical upgrades.

2.4 Copyright

This document is copyright-protected. Any reproduction or copying, in whole or in part, as well as the reproduction of images, even when changed, can only be carried out with the written agreement of the manufacturer.

2.5 Symbols used

DANGER

A warning at this danger level designates an imminently dangerous situation.

If the dangerous situation is not avoided, it will lead to death or serious injury.

► To avoid the danger, follow the instructions shown.

CAUTION

A warning at this danger level designates a possibly dangerous situation.

If the dangerous situation is not avoided, it can lead to injury.

► To avoid the danger, follow the instructions shown.

NOTICE

A warning at this danger level designates possible property damage.

If the dangerous situation is not avoided, it can lead to property damage.

► To avoid the danger, follow the instructions shown.

NOTE

► This advice designates additional information that simplifies operation of the device.

2.6 Intended use

This equipment is to be used exclusively to clip cattle and horses.

Any other use or use extending beyond the above is considered unauthorised.

CAUTION

Danger from unauthorised use!

Danger can result from unauthorised and/or other kind of use.

► Use the device only as intended.

► Limit yourself to the procedures described in these operating instructions.

Claims of any nature for damage resulting from unauthorised use will not be recognised.

Such use is entirely at the own risk of the operator.

CAUTION

Risk due to incorrect use!

In particular, the following applications of the device are prohibited:

- ▶ Use of the device on humans.
- ▶ Clipping of other types of animals, especially dangerous animals such as predators.

3 Safety

3.1 General

DANGER

Danger from not respecting the safety instructions!

Ignoring the operating instructions and safety precautions presented in these operating instructions will lead to serious injury as well as damage to the device and people.

- ▶ The warnings and instructions in these operating instructions must be observed.

Observe the following safety instructions:

- Do not leave the clipper unattended when switched on.
- Store the clipper out of reach of children.

3.2 Personnel requirements

- This clipper may only be operated by persons who can be expected to carry out their work responsibly. Persons whose ability to react is undermined by, for example, drugs, alcohol or medication should not be allowed to use the device.
- The operator must be experienced in dealing with the animals to be clipped.
- Children (< 8 years) are strictly prohibited from operating the device.

Unauthorised persons

CAUTION

Danger for and from unauthorised persons!

Unauthorised persons who do not meet the requirements described here will not be able to recognise dangers in the work area.

- ▶ Prohibit access by unauthorised persons to the location where the clipping is being performed.
- ▶ If in doubt, approach the persons and instruct them to leave the work area.
- ▶ Suspend work until the unauthorised persons have left the work area.

3.3 Dangers that can be caused by the device

3.3.1 Danger from electrical current

DANGER

Mortal danger from electrical current!

Mortal danger can result from contact with current-carrying conductors or components!

- ▶ Only permit repairs to the clipper to be made by authorised dealers or the factory customer service department; this applies especially to the replacement of a damaged power cord on the charger.
- ▶ Keep moisture away from the clippers. It can lead to short circuits. If you suspect that moisture has penetrated the device, do not switch it on again and take it to a repair shop.
- ▶ Never clip wet animals.
- ▶ Never submerge the clipper in water or other liquids.
- ▶ Always disconnect the charger's power cord from the mains by pulling the plug, not the cord.
- ▶ Before every use, check the clipper for externally visible damage. Do not operate a damaged clipper.
- ▶ Only ever insert the charger's electrical plug into an undamaged socket.
- ▶ Never wrap the power cable around the clipper and keep it away from hot surfaces and objects.
- ▶ Before plugging in the charger, compare the electrical connection data (voltage and frequency) on the nameplate with that of your electric mains. These data must be identical so that no damage occurs to the device. When in doubt, ask your specialised electrical dealer.
- ▶ Do not, under any circumstances, open the housing of the clipper. If voltage-bearing connectors are disturbed or the electrical and mechanical construction is modified, there is risk of electric shock.
- ▶ Only clean the clipper when dry, using a brush or the enclosed cleaning brush.
- ▶ Always switch the clipper off before working on it and remove the battery from the device.
- ▶ Only use original batteries.
- ▶ Do not expose the charger and the batteries to direct sunlight or humidity.

3.3.2 Clipping blade

CAUTION

Danger from moving components!

The moving clipping blade and its sharp edges can cause injuries.

- ▶ Proceed with caution when working.
- ▶ Avoid any contact with the moving clipping blades.
- ▶ Do not touch the area around the clipping blade while it is still plugged into a power source, even when the equipment is turned off. For work on the clipping blade/clipping head, always disconnect the electrical power first.

CAUTION

Danger of burns!

Insufficient oiling of the clipping head leads to warming. This may agitate the animals.

- ▶ When clipping, oil the clipping blades and clipping head through the lubrication opening provided for this purpose at least every 15 minutes so that the blades do not run dry.

3.3.1 Batteries

CAUTION

Risk of injury if the batteries are not used correctly!

Rechargeable batteries must be handled with special care.

- ▶ Only use original batteries.
- ▶ Do not throw the batteries into fire or expose them to high temperatures. Risk of explosion.
- ▶ Only use undamaged batteries.
- ▶ Do not expose the batteries and charger to direct sunlight or humidity.
- ▶ Never short circuit the batteries. Overheating caused by short-circuiting can cause the battery to set on fire.
- ▶ Never open the batteries. Leaking liquid caused by incorrect use can cause skin irritation. Avoid contact with the liquid. Rinse off any liquid immediately. If the liquid gets into your eyes, rinse your eyes out immediately for 10 minutes with water and consult a doctor without delay.

3.3.2 Animals

CAUTION

Danger of injury by animals!

The noise of the equipment can disturb animals. A kick, an attack or the body weight of the animal can lead to injuries.

- ▶ Only persons who have experience with the animals to be clipped are permitted to clip the animals.
- ▶ Secure the animal sufficiently and calm it before starting work.
- ▶ Proceed with caution when working.
- ▶ Call in a second person if necessary.

NOTE

Reduced battery service life caused by incorrect use!

The battery's performance can be reduced if the battery is used incorrectly.

- ▶ Only use the original charger. Other charging devices can damage the battery.
- ▶ Disconnect the charger from the power supply when it is not used for extended periods.
- ▶ Remove the battery from the charger if the charger is not connected to the power supply.
- ▶ Never insert other objects into the opening of the charger or in the battery holder on the device.
- ▶ Replace any no-longer rechargeable batteries as they damage the charger.

3.4 Personal Protective Equipment (PPE)

CAUTION

Danger of injury through incorrect or missing protective equipment!

Personal protective equipment is required when working, in order to minimise the possibility of endangering health.

- ▶ Always wear the protective equipment required for the current task when performing work.



Slip-resistant shoes to protect against slipping on slippery surfaces.



Protective goggles to protect eyes from flying parts.



Close-fitting protective clothing with low tensile strength, tight sleeves and no protruding parts. Their primary purpose is to prevent being caught between moving machine parts.

Do not wear rings, chains or other jewellery.



Wear work gloves to protect against injury.



The acoustic emission while operating the device is typically 65 dB(A). We recommend that you always wear ear protection when working with the device.

4 Specifications

Subject to changes and improvements in the interest of technical advances.

4.1 Clipper

Handle	Ø 54 mm
Length	280 mm
Weight with battery	1.02 kg
Motor power	} see specifications plate on the device
Speed	
Noise emission	65 dB (A) (EN 60745-1:2009)
Uncertainty K	3 dB (A)

4.2 Charger and power pack

Voltage	} see specifications plate on power pack and charger
Max. current consumption	
Frequency	

4.3 Battery

Type	Li-Ion
Voltage	10,8 V
Capacity	see specifications plate on the battery

4.4 Operating conditions

Ambient temperature range	0 - 40 °C
Maximum relative humidity	75 %

5 Construction and functions

5.1 Construction

- 1 Clipping blade
- 2 Clipping head
- 3 Lubrication opening
- 4 Clipping pressure adjustment
- 5 Motor unit
- 6 ON/OFF switch
- 7 Battery latch
- 8 Cord



Abb. 1

5.2 Functional description



Abb. 2

The clipper is used for clipping cattle and horses. Two comb-like blades serve as cutting tools. The lower blade (2), which is closest to the animal's skin, is fixed and attached to the housing. The upper blade (3) moves back and forth against the lower blade. The upper blade is set in motion with the help of a swivelling lever. The clipping pressure between the blades is adjusted via the adjustable head (1).

6 Transport, packaging and storage

6.1 Box contents

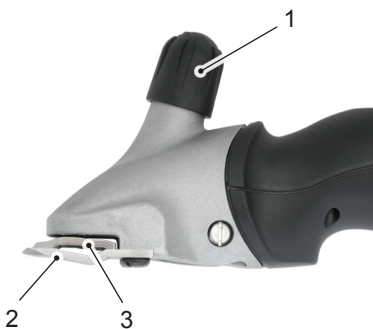
- 1 Clipper
- 1 pair of clipping blades
- 1 charger
- 1 backup battery (depending on device)
- 1 power pack with plug
- 1 special screwdriver
- 1 bottle of special lubricating oil
- 1 cleaning brush
- 1 case for transport and storage
- 1 operating instructions

NOTE

- Check to ensure the completeness of the contents and that there is no damage. Please report incomplete package contents or any apparent damage immediately to your supplier/dealer.

6.2 Packaging

Only environmentally friendly materials are used for packaging.



The return of the packaging saves raw materials and reduces the volume of waste. Dispose of packaging materials that are no longer needed in accordance with locally applicable regulations.

6.3 Storage

Store the clipper and accessories under the following conditions:

- Do not store outside.
- Keep dry and dust-free.
- Protect from direct sunlight.
- Avoid mechanical shock and vibration.
- Storage temperature: 0 to 40 °C.
- If stored for longer than three months, check the general condition of all parts regularly.
- When not using the clipper, store it in the case making sure it is well cleaned, lubricated and that the clipping elements are not spring loaded (risk of corrosion).

7 Operation

7.1 Requirements at the place of use

- Observe the manual (see chapter **Specifications**).
- Outdoor electrical sockets must be fitted with a residual current device (RCD).
- The work place must have adequate lighting.
- The electrical socket must be easily accessible so that the device can be quickly disconnected from the mains.
- It must be used beyond the reach of children.
- The charger's power cord must not be taut or kinked.
- Make sure there is adequate ventilation.

7.2 Setting up the charger

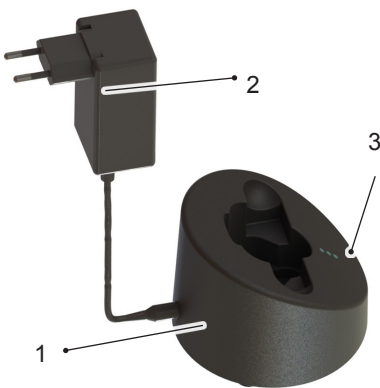

- ◆ Position the charger (1) on a fixed, level, dry and clean surface.
- ◆ Connect the AC adapter (2) to the charger.
- ◆ Plug the AC adapter into the power socket.
- ◆ The continuous green light on the lower LED (3) signals that the AC adapter is correctly plugged into the power socket and the charger is supplied with power. The charger is ready to operate (see also **Chapter 6.4**).

Abb. 3

7.3 Charging the batteries

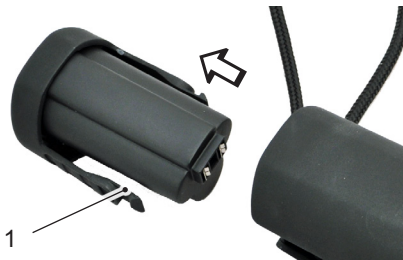

- ◆ Press both sides of the battery latch (1) and remove the battery.
- ◆ Check the battery terminals for foreign objects and dirt.

Abb. 4



Abb. 5

- ◆ Without applying force, insert the battery from above into the designated charging bay on the charger.



Abb. 6

- ◆ The battery is charged. The status of the charging process is displayed using LEDs (see also **chapter 6.4**). As soon as the battery has finished charging, all LEDs change from red to green and the charger switches to "trickle charging".

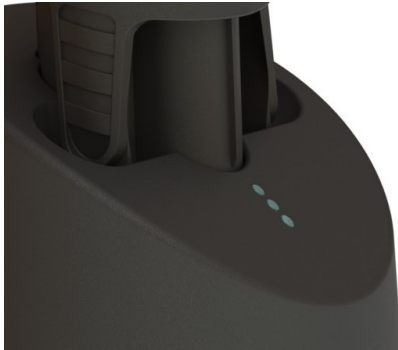

Abb. 7

- ◆ Push the charged battery into the clipper until the battery latch (1) engages on both sides.

7.4 Charging status display

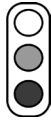

The LEDs are shown as follows in these operating instructions:

- 1 LED switched off
- 2 LED lights up red
- 3 LED lights up green



Four charging statuses are displayed with the LEDs:

AC adapter connected

The continuous green light on the lower LED signals that the AC adapter is correctly plugged into the power socket. The charger is supplied with power and is ready to operate.

Normal charging

The three LEDs light up red if the battery is discharged. The green light indicates that the battery is charged. The charging process is displayed differently depending on the residual voltage:

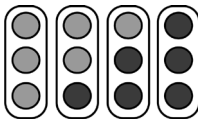

Discharged battery, 0 % battery charge

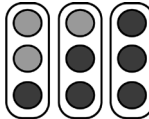

approx. 30 % battery charge

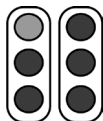

approx. 75 % battery charge

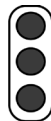

approx. 90 % battery charge

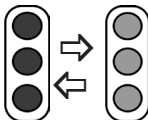

Deep discharging

With a deeply-discharged battery, the LEDs flash red and green alternately. The charger attempts to charge the battery. If the voltage does not increase after a short while, the display shows "Battery defective". If it is successful, normal charging starts.

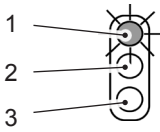

Defective battery

If the battery cannot be charged or the battery is defective, the top LED flashes red.

7.5 Adjusting the clipping pressure



Abb. 8

Set the clipping pressure as follows before you start clipping:

- ◆ Turn the adjusting knob in the direction of the arrow until you feel resistance.
- ◆ Turn the knob another 1/4 turn in the direction of the arrow.
- ◆ If the clipping quality deteriorates, increase the clipping pressure by turning the adjusting knob another 1/4 turn in the direction of the arrow. If this does not produce the desired result, the blades must be replaced or sharpened.

NOTE

- ▶ If the clipping pressure is too low, hair can gather between the clipping blades. This results in a poor clipping quality. In this case, clean the clipping blades as described in **chapter 6.10**.

7.6 Switching the clipper on and off.



Abb. 9

- ◆ To switch the clipper on, slide the ON/OFF switch to the position **I**.
- ◆ To switch the clipper off, slide the ON/OFF switch to the position **0** (see Fig. 9)

7.7 Using the clipper

- ◆ Approach the animal from the front.
- ◆ Secure the animal to be clipped and calm it down.
- ◆ Switch the clipper on while you are in the visual range of the animal.
- ◆ Observe the animal's behaviour while clipping.

- ◆ Switch the clipper off after you have finished clipping.

7.8 Replacing the clipping blades



Abb. 10

- ◆ Switch the clipper off by sliding the switch to the position "0".
- ◆ Turn the adjusting knob in the direction of the arrow until the resistance decreases.
- ◆ Place the clipper with the comb plate screws facing up onto a flat surface.



Abb. 11

- ◆ Loosen the comb plate screws and remove the clipping blade.



Abb. 12

NOTE

- ▶ Make sure the clipping blades are positioned correctly when installing the new or sharpened blades.

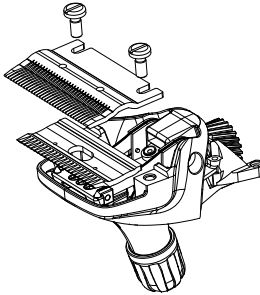

Abb. 13

- ◆ Place the new upper blade onto the guiding tips of the swivelling lever.
- ◆ Apply a few drops of oil on the polished surfaces of the upper blade.

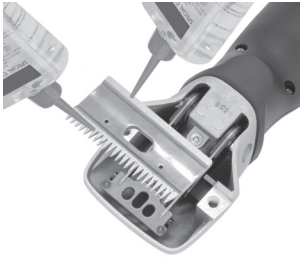

Abb. 14

- ◆ Install the new lower blade. Align it so that the ground surface of the lower blade protrudes approx. 1.5 - 2 mm above the point of the upper blade.
- ◆ Tighten the comb plate screws.

NOTE

- ▶ Work only with sharp clipping blades and replace dull blades and blades with missing teeth. Proper sharpening of clipping blades is only possible by an expert using specialised equipment. When faced with the need to sharpen the blades, contact your service centre.

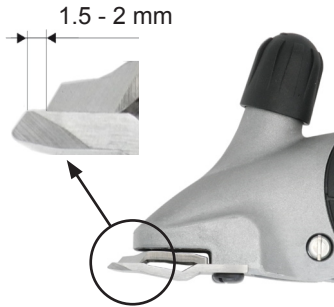
7.9 Lubrication



Abb. 15

To achieve a well-clipped animal and to increase the life of the device including the clipping head, it is necessary to apply a thin coat of oil between the upper and lower blades. All other moving parts of the clipping head must also be lubricated.

- ◆ Apply some drops of oil onto the clipping blades and into the lubrication opening.

NOTICE

Possible damage to the clipper!

Insufficient oiling of the clipping head will lead to warming and will shorten the life of the clippers and its blades.

- ▶ Oil the clipping blades adequately during the clipping session, at least once every 15 minutes, so that they do not run dry.
- ▶ Only use the special oil supplied or a paraffin oil conforming to the ISO VG 15 specification.

NOTE

- ▶ The supplied oil is free of poisonous substances and will not cause irritations on either skin or mucous membranes. After 21 days, it will have degraded to about 20% (CELL-33-T-82).

- Oil the blades prior to, during and after every use.
- Oil the blades at the latest when the blades leave streaks or slow down.
- Apply several drops of oil on the front and on the sides of the clipping blades (see Fig. 15).
- Immediately replace damaged or notched blades in order to avoid injuries.

7.10 Cleaning

Housing of the clipper

- ◆ Clean the housing of the clipper with a dry cloth.

Clipping blade, clipping head and charger

- ◆ Disconnect the charger from the power supply.
- ◆ Use the brush supplied to clean the clipping blades, clipping head and charger.
- ◆ Lubricate the clipping blades as described in **chapter 6.9**.
- ◆ Remove any hair from the charging bay.
- ◆ Clean the terminals with a dry cloth if necessary.

8 Troubleshooting

8.1 Safety instructions

DANGER

Mortal danger from electrical current!

Mortal danger can result from contact with current-carrying conductors or components!

- ▶ Switch the equipment off before troubleshooting the problem.
- ▶ Repairs to electrical devices must only be carried out by the factory service department or specialists who have been trained by the manufacturer.

8.2 Causes of malfunctions and their rectification

Malfunction	Possible cause	Corrective measure
Upper blades moving too little.	Leaf springs have broken.	Notify customer service.
	Square end of eccentric shaft or eccentric shaft worn (insufficient lubrication).	
Upper blade does not move.	Defective gear.	Notify customer service.
Adjusting knob is jammed.	Thread is dirty or rusty.	Notify customer service.
	Pressure spring is jammed.	
Leaf springs in the head mount are too loose.	Comb plate screws are loose.	Tighten the comb plate screws.
Play between swivelling lever and leaf spring.	Leaf springs and/or cylinder head screws are worn.	Notify customer service.
Swivelling lever is difficult to move up and down.	Centring sleeve lost.	Notify customer service.

Malfunction	Possible cause	Corrective measure
Clipper is cutting poorly or not at all.	Clipping blades are dull.	Notify customer service.
	Clipping blades are not properly sharpened.	
	Clipping blades are not lubricated.	Lubricate the clipping blades every 15 minutes.
	Clipping pressure too low.	Increase the clipping pressure as described in chapter 6.5 .
	Leaf springs have broken.	Notify customer service.
	The animal's hair is too wet.	Only clip dry hair.
	Hairs are stuck between upper and lower blade.	Remove the clipping blades; clean, lubricate and install them again; set the clipping pressure.
	Clipping head has too much play.	Notify customer service.
	Clipping blades are not properly aligned.	Align the clipping blades correctly, see Fig. 14 .
Motor not running.	Battery is discharged.	Charge battery.
	Terminals are dirty.	Switch off the clippers. Clean the terminals of the clipper and battery.
	Battery is faulty.	Replace battery.
	Burnt smell emanating from the motor housing/motor burnt.	Notify customer service.
	Clipping head jammed.	Remove jamming.
	Motor and/or electronics defective.	Notify customer service.
Motor runs very slowly.	Clipping blades not lubricated adequately.	Lubricate the clipping blades.
	Clipping pressure too strong.	Reduce the clipping pressure, as described in chapter 6.5 .
	Battery is almost discharged.	Charge battery.
	Motor and/or electronics defective.	Notify customer service.
Motor unit heats up.	Clipping pressure too strong.	Reduce the clipping pressure, as described in chapter 6.5 .
	Motor defective.	Notify customer service.

Malfunction	Possible cause	Corrective measure
Battery charge runtime too short and/or blades become hot.	Clipping blades not lubricated adequately.	Oil clipping blades.
	Discharged, not fully charged or defective batteries were used.	Only use intact, fully charged original batteries.
Lowest LED on charger is not lit.	The charger is not connected to the power supply.	Connect charger to the power supply.
	Electronics or power pack is defective.	Notify customer service.
Normal charging does not start when the discharged battery is inserted.	Battery terminals and/or charger are dirty.	Clean the terminals.
	Battery is faulty.	Replace battery.
	Electronics are defective.	Notify customer service.
Lowest LED alternates between green and red.	Battery is deeply discharged, the charger is trying to boost the battery voltage.	If it is successful, normal charging starts. (store batteries that have never discharged).
		If it is not successful, the lowest LED lights up red (see the following table).
Top LED lights up red.	Battery is faulty.	Replace battery.

9 Spare parts

See spare parts list at the end of these operating instructions.

CAUTION

Incorrect or defective spare parts can lead to damage, malfunction and complete failure and can jeopardise safety.

- ▶ Use only original spare parts from the manufacturer. Obtain spare parts from an authorised dealer or directly from the manufacturer.

NOTE

- ▶ If non-approved parts are used, all warranty, service, compensation and liability claims against the manufacturer or its employees, dealers and representatives will be forfeited.

Item	Description	Total	Item	Description	Total
	Clipper		32	Catch spring for switch	1
1	Clipper head cattle complete	1	33	Motor housing lower	1
2	Tension nut cattle	1	34	Motor holder at front	1
3	Distance screw	1	35	Motor holder at rear	1
4	Tension sleeve	1	36	Li-Ion battery	1
5	PH-Screw M5 X 14	2	37	PCB device	1
6	Clipper head case	1	38	Switch contact	1
7	Pressure spring	1	39	Countersunk slotted screw M2.6 x 6	2
8	Pressure plate	1	40	Motor housing upper, pre-assembled, including switch lever	1
9	Crank drive block	1	41	Cord	1
10	Socket head cap screw partially threaded M3 x 6	2	45	Motor complete	1
11	Laminated spring	2	50	Complete charger	1
12	Driving carrier	1	51	Top of housing for charger	1
13	Comb screw cattle/horse	2	52	PT screw KA30 x 16	15
14	Centering bush complete	2	53	Base plate for charger	4
15	Circlip for shaft size 3.73	1	54	Light conductor	1
16	Circlip for shaft size 6	1	55	PCB charging station	1
17	Crankshaft cattle	1	60	Power pack	1
18	Crank spindle sleeve complete	1	61	Connector EU	opt.
19	Cogwheel Z22 cattle	1	62	Connector AUS	opt.
27	Rubber base	3	63	Connector GB	opt.
30	Upper housing cover	1	64	Connector US	opt.
31	Switch lever	1			

10 Disposal



NOTICE

Environmental damage if improperly disposed of!

- ▶ Special waste handling is required for electrical waste, lubricants and other tools. These can only be disposed of through qualified specialists!

NOTE

- ▶ Dispose of the clipper at a service centre or nearby electrical workshop.

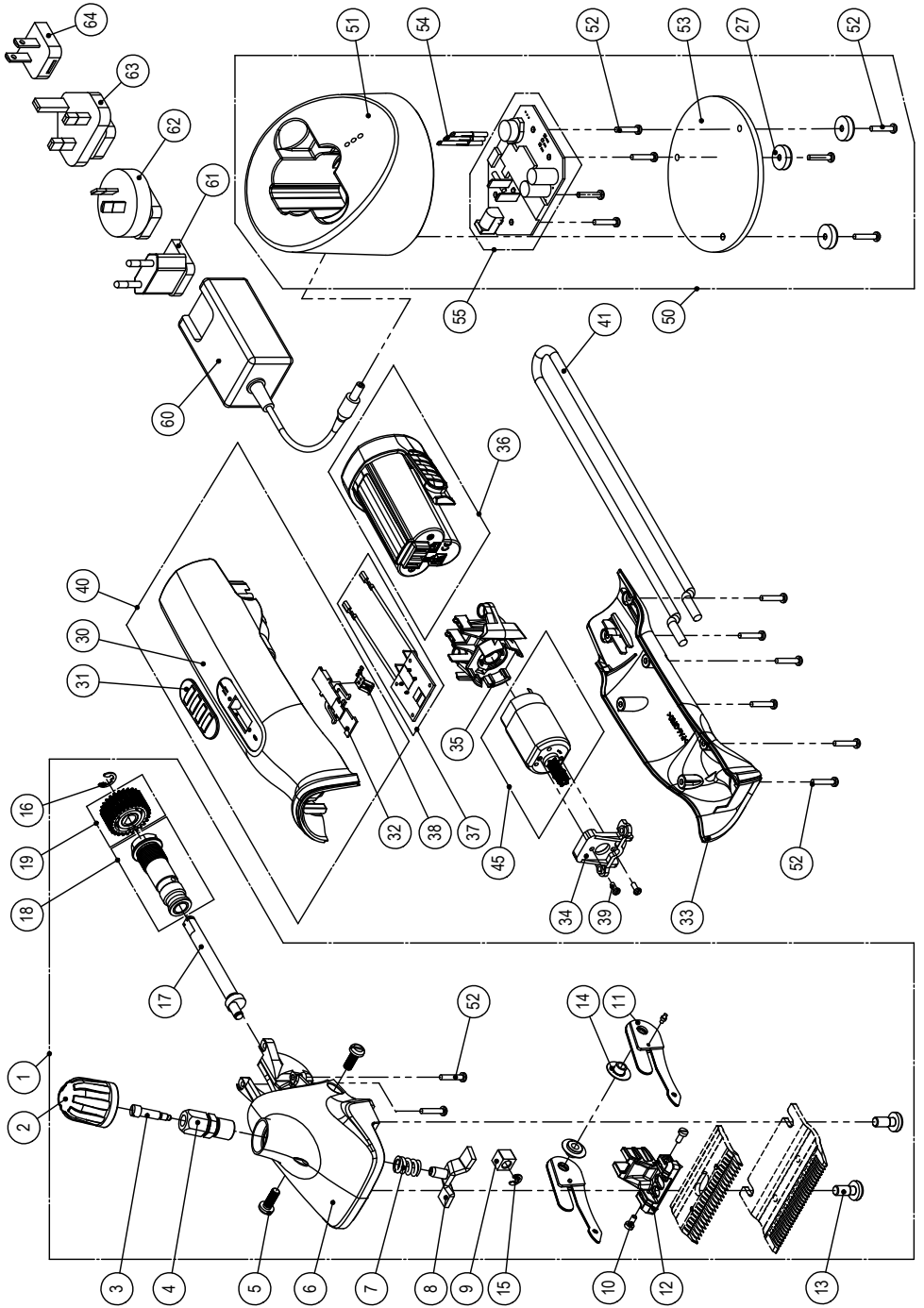

garantía

Artikel
Item
Article
Articolo
Artículo
Artico

Artikel
Artikel
Artikel
Artikkel
Tuote
Προϊόν

garantie

Serien Nr.
Serial no.
No. de série
No. di serie
No. de serie
No. de série

Serie nr.
Serie Nr.
Serienr.
Serie nummer
Sarjanro
Αρ. σειράς

warranty

Kaufdatum
Date of purchase
Date d'achat
Data di vendita
Fecha de compra
Data de compra

Datum van aankoop
Købsdato
Köpdatum
Kjøpsdato
Ostopäivä
Ημερομηνία αγοράς

Stempel und Unterschrift
Stamp and signature
Cachet et signature
Timbro e firma
Sello y firma
Carimbo e assinatura
Stempel en handtekening
Stempel og underskrift
Stämpel och namnteckning
Stempel og underskrift fra forretningen
Myyjän leima ja allekirjoitus
Σφραγίδα και υπογραφή