

QuickClean Bucket Waterer

#54022519



www.premier1supplies.com

800-282-6631

© Copyright 2016, Premier1Supplies.
All rights reserved.

Replacement Parts:

1. #54022521 Threaded bolt
2. #54022502 Rubber seal
3. #54022503 Bucket
4. #54022524 Flow valve
5. #54022505 Rubber valve
6. #54022506 Diaphragm/float
7. #54022527 Triangle valve
8. #54022528 Green plastic base
9. #54022529 Plastic nut
10. #54022530 Valve cover
11. #54022531 Handle
12. #54022532 Lid
13. #54022520 Set of legs

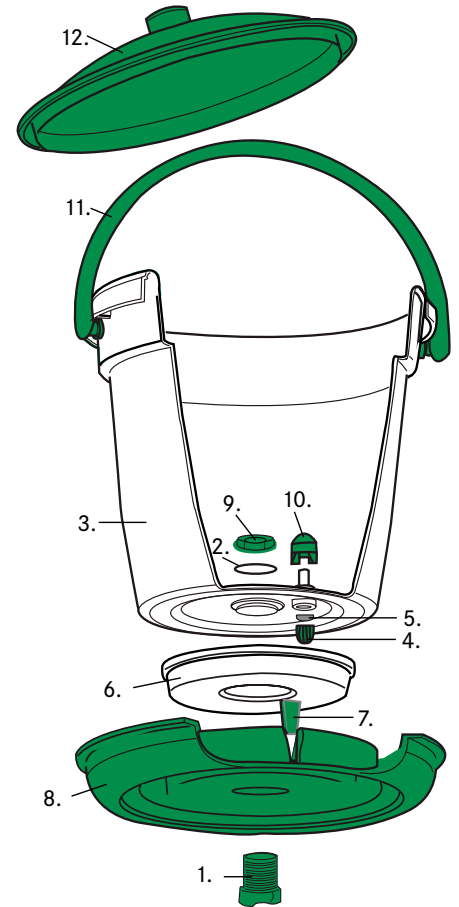

A) Screw legs into waterer base (8).



B) Insert threaded bolt (1.) through bottom of base.



C) Set the large white plastic "diaphragm" (6.) onto the base of the bucket (8.). Place it so the larger diameter side is against the bucket.



D) Press triangle valve (7.) (with the smooth side of the triangular piece facing the outside) into green base (8.).



E) Place flow valve (4.), which includes rubber valve (5.) into base of white bucket. Flat rubber piece against the bucket.



G) Flip bucket (3.) over so it rests on the green base (8.).



H) Place seal (2.) over the threaded bolt (1.).



J) Take the green valve cover (10.) and firmly insert it onto the elevated plastic cone on the inside of the bucket.



K) Take the plastic handle (11.) and snap both pieces into the slots on the bucket (3.). This will require reasonable pressure and force. There will be a definite "pop" sound when these have been properly installed.



L) Fill with water and place the green cover (12.) on top of the bucket. Install by setting the waterer on level ground.