

# QuickClean Bucket Waterer #540072

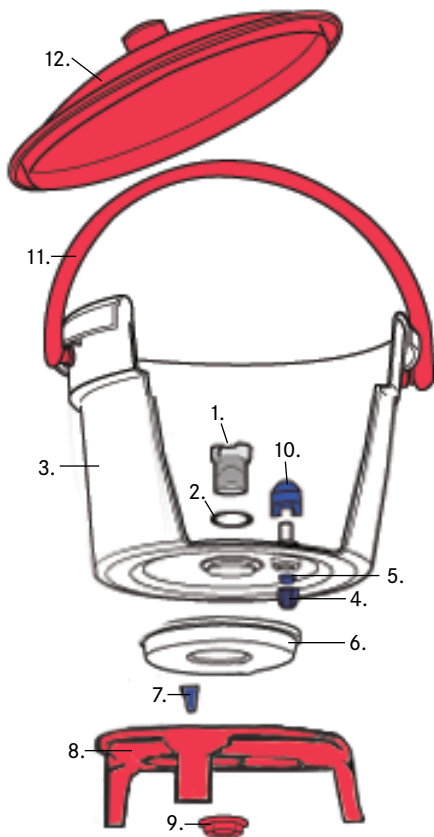

A) Put rubber seal (2.) onto the clear threaded plastic bolt (1.).



B) Insert the clear plastic bolt into the bottom of the white pail (3.). Put threads in first and twist it into place by turning it clockwise (this will keep this piece in place during other parts of assembly).



C) This photo shows how your waterer should appear thus far.



D) Insert rubber plug (5.) into the blue valve cap (4.) if not already assembled like this. Place this piece (rubber part first) into the small round hole in the base of the white pail (3.).



E) Set the large clear plastic "diaphragm" (6.) onto the base of the white pail (3.). Place it so the larger diameter side is against the pail.



F) Insert the small blue triangle piece (7.) into the red base (8.). Push in with the smooth side of the blue piece facing the outside. It will "pop" when put correctly inserted.

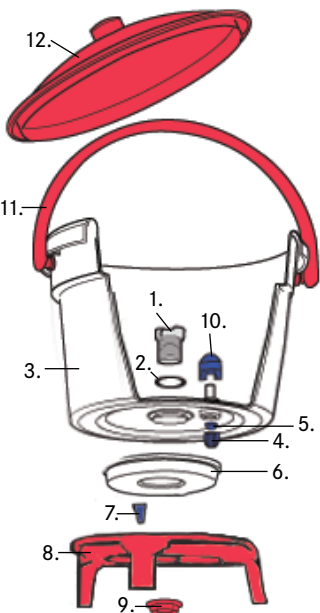

G) Set the red base (8.) onto the white pail (3.).



J) Flip the waterer so it rests on the red base. Take the blue plastic cap with 3 legs (10.) and firmly insert it onto the elevated plastic cone on the inside of the white bucket.



H) Place red hexagon nut (9.) with the larger end first onto the clear plastic bolt (1.). Turn clockwise (a few turns are sufficient to keep the pieces together).



K) Take the plastic handle (11.) and snap both pieces into the slots on the white pail (3.). This will require reasonable pressure and force. There will be a definite "pop" sound when these have been properly installed.



I) Position the red hexagon nut (9.) into the recessed portion of the red base (8.). Hold the nut in place and begin tightening the threaded bolt (1.) clockwise until firmly in place.



L) Fill with water and place the red cover (12.) on top of the pail. Install by setting the waterer on level ground.

## Replacement Parts:

- 1. #53002501 Threaded plastic bolt
- 2. #53002502 Rubber seal
- 3. #54007203 Bucket
- 4. #53002504 Flow valve
- 5. #53002505 Valve insert
- 6. #53002506 Diaphragm/float
- 7. #53002507 Triangle valve
- 8. #54007208 Bottom with legs
- 9. #53002509 Plastic nut
- 10. #53002510 Valve cover
- 11. #53002511 Handle
- 12. #53002512 Lid



[www.premier1supplies.com](http://www.premier1supplies.com)

800-282-6631