

Canal Portable Waterer

www.premier1supplies.com • 800-282-6631 • Washington, IA

© Copyright 2022, Premier1Supplies. All rights reserved.



#938210

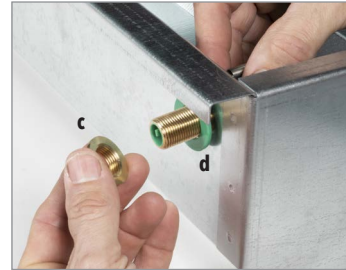
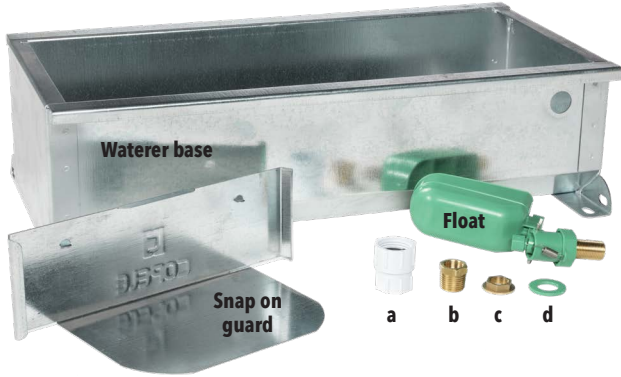

1. Insert float through waterer, place washer "d", thread on nut "c".

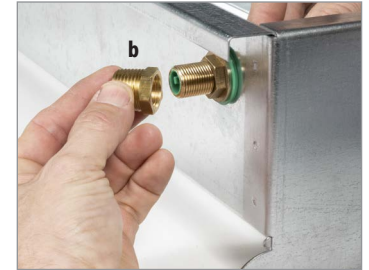

2. Thread adapter "b" with washer onto float.



3. Pipe tape may be required between a/b connection.



4. Thread garden hose adapter into place.



5. Turn adjustment screw to adjust water level.



6. Top view of float. Adjust screw from top of float.