

Ercolino Grinder Assembly Instructions

#530075

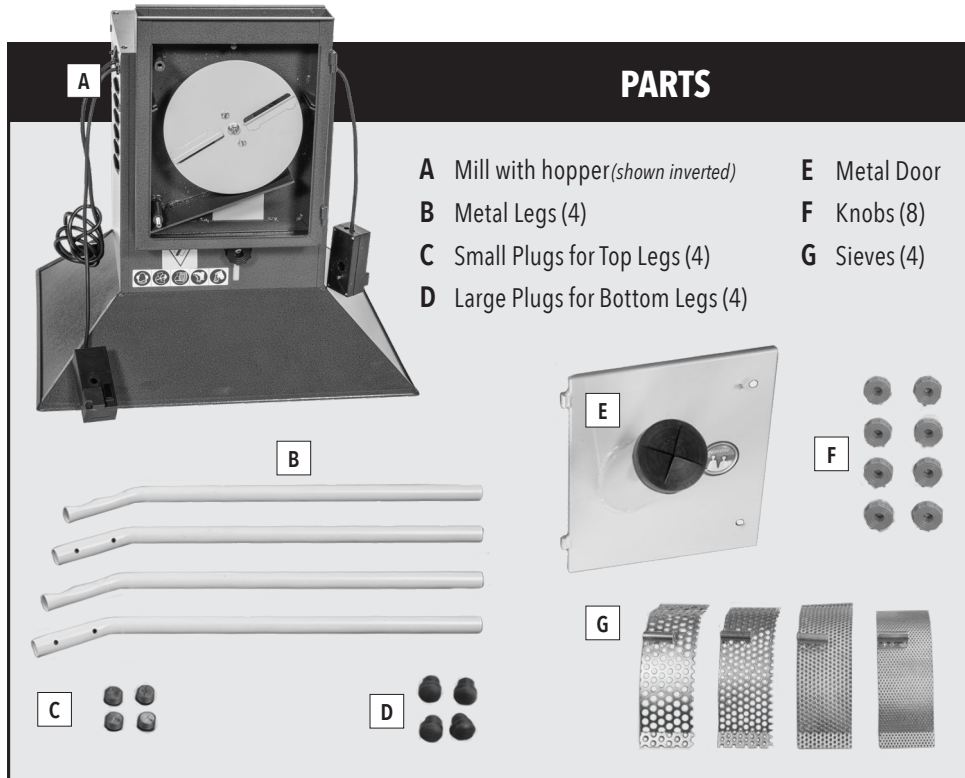

STEP 1

Install plugs into the top and bottom of legs (B). Small plugs (C) go into the top and large plugs (D) go into the bottom.

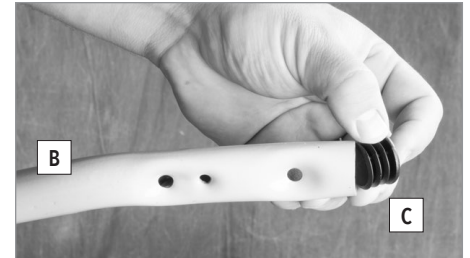

STEP 2

With the mill set on the hopper (A). Attach the legs via the threaded knobs (F).

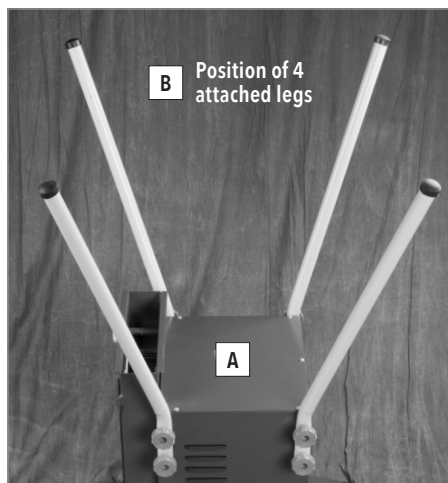
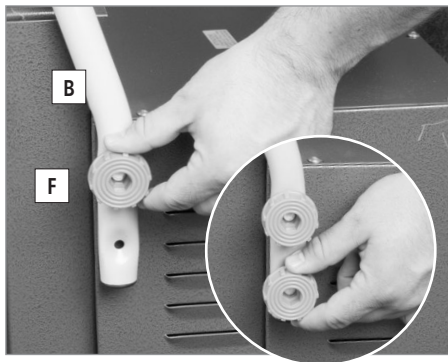

STEP 3

Set the grinder on its legs. Insert sieve (G) as shown at right. Ends of sieve fit into the slots on either side of the wheel (as shown). Sieve tube fits over the guide post beneath the wheel.

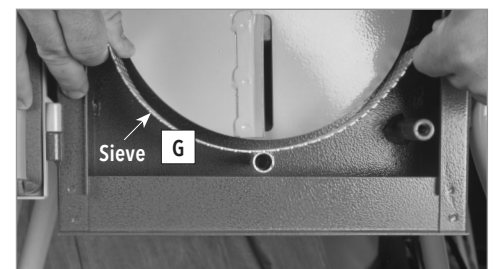

STEP 4

Place metal door (E) on hinges. Unscrew the bottom knob (see inset). Close the door and fasten the bolt/knob into the bottom hole.

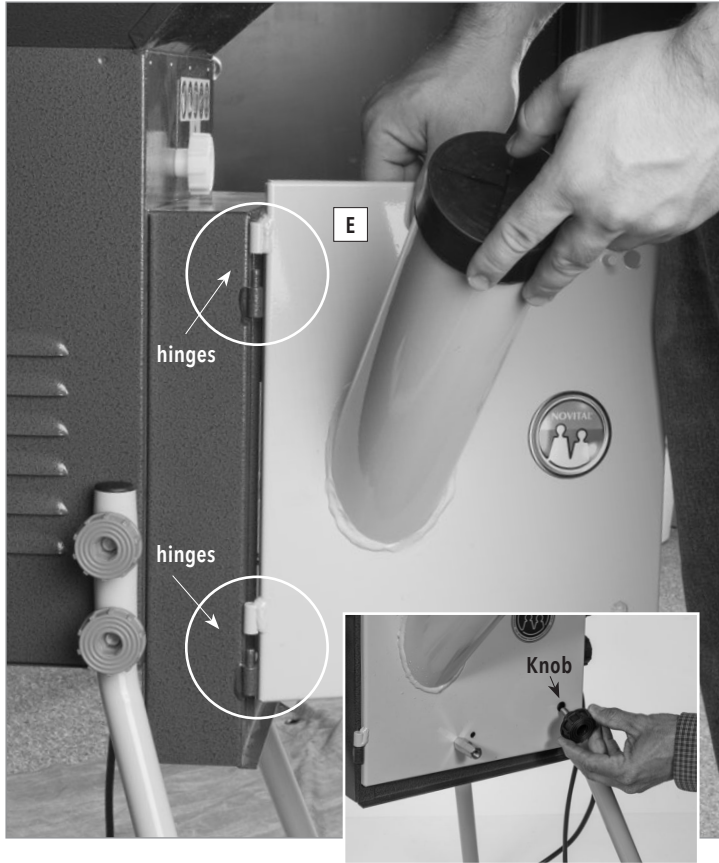

STEP 5

(left photo) Mount the ECU unit (bottom) by placing it over the hex connector and fixed stud. Tighten bolt/knob.

(right photo) Thread remaining hex connector onto remaining threaded stud at top right of door. Mount and affix the ECU unit (top) with bolt/knob.

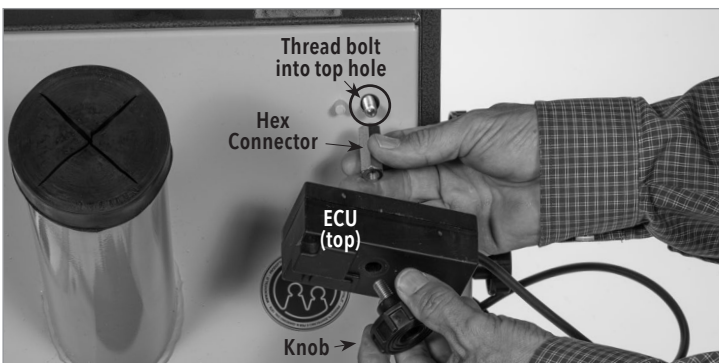
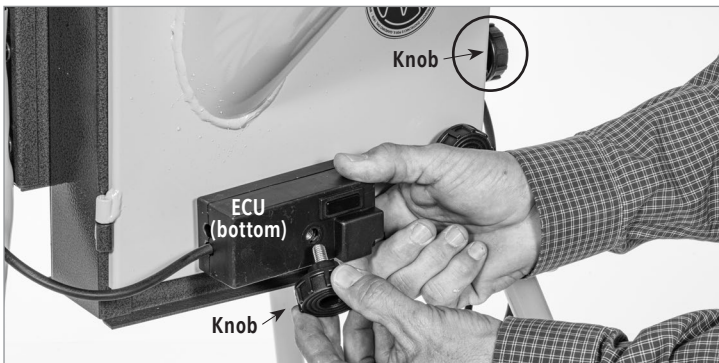

Completed Assembly



Troubleshooting

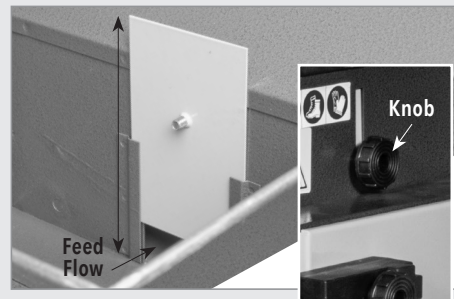

Feed flow
Control by using knob (see inset) above the door (E). Loosen knob and lift. Tighten when you reach desired feed flow.



Reset Button
Located near the inlet power cord.



www.premier1supplies.com
800-282-6631

©Copyright 2025, Premier1Supplies. All rights reserved.