

# Galvanized Cone Feeders

#540055, 540056, 540067

800-282-6631 | [www.premier1supplies.com](http://www.premier1supplies.com)

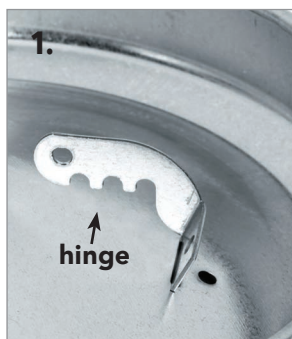

## Attaching the Hinge

### NO LEGS

1. Insert hinge into slot at base of trough.
2. Insert screw into base of the hinge and trough.
3. Secure via locknut.

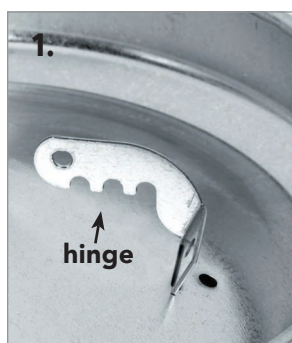

## Attaching the Hinge

### PLASTIC LEGS

1. Insert hinge into slot at base of trough.
2. Insert screw through plastic foot, into base of the hinge and trough. Bottom of hinge fits foot slot.
3. Secure via locknut.

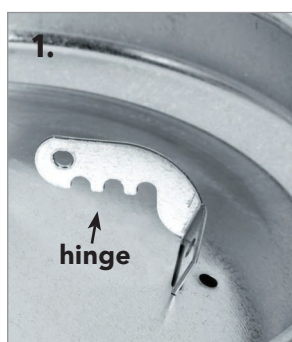

## Attaching the Hinge

### METAL LEGS

1. Insert hinge into slot at base of trough.
2. Insert screw through bracket, into base of the hinge and trough. Squeeze **metal leg(s)** and insert into slots on bracket.
3. Secure via locknut.

## Attaching Cone to the Base

4. Position cone base into two of the adjustment hinges. Lip of the cone should fit into their cutouts.
5. Twist the cone until the seam lines up with the empty hinge. Press into the base of the cone with your thumbs, while pushing on the side of the trough with your fingers. The seam will flex inward to catch under the hinge.
6. Adjust the rest of the feeder base to the desired height.

